

Sama+ Meeting Room

(Varies - up to 4 pax, up to 8 pax)

A more traditional meeting room setting for serious decision-making or any not-so-serious strategic-planning session.

Public:

- Small – 45 / 2 hour
- Medium – 50 / 2 hour
- Large – 75 / 2 hour

Members:

- Small – 30 / 2 hour
- Medium – 40 / 2 hour
- Large – 60 / 2 hour

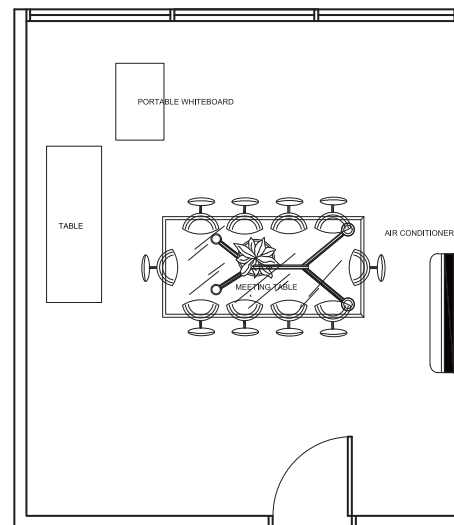

MEETING ROOM 1 SETUP PLAN
NOT TO SCALE

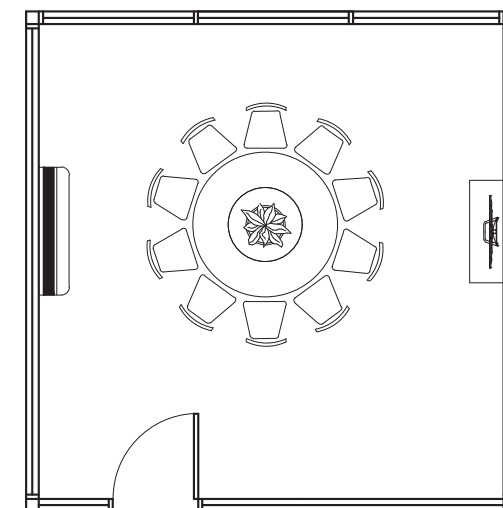

MEETING ROOM 2 SETUP PLAN
NOT TO SCALE